

Rev.No.	Ch.Let	Alterations	Date	Sign.	Appd.

All Dimensions are in MM

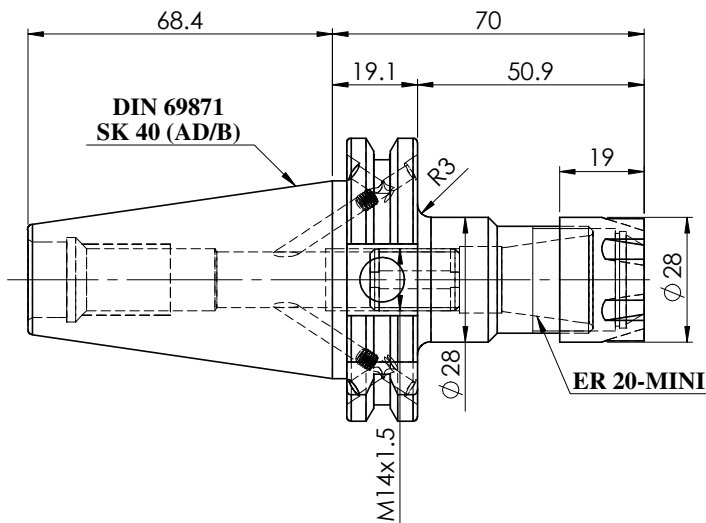
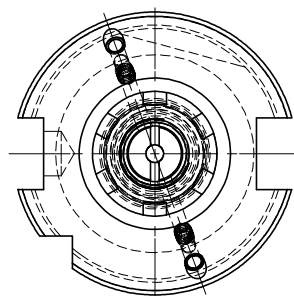
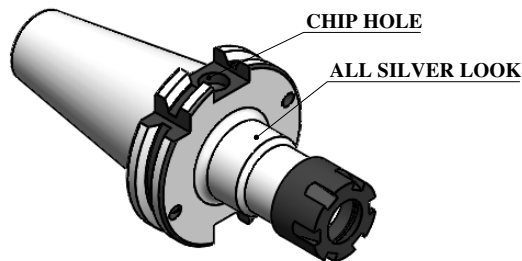

LABEL:

2002262.0400
SPANNZANGENFUTTER
ER COLLET CHUCK HOLDER
ISO 7388 - 1 (DIN69871) SK40 AD/AF(AD+B)
ER20M x 070 mm
G2.5 / 25000 U/MIN

NOTE:

BALANCING 2.5G @ 25000 RPM

WEIGHT : 0.9 Kg

MARKING : ISO 7388 - 1 (DIN 69871) SK40 AD/AF (AD+B) CCH ER20M H070
G2.5 25000 U/MIN

ITEM NO.	PART NUMBER	DESCRIPTION	QTY.
1	FWS409H-ERM20070	SK40CCHER20070MFWW	1
2	NUTER20M	COLLET NUT	1
3	FTSCWM14X1.5	STOPPER SCREW	1
4	GS-M4X4	GRUB SCREW	2

µm	0.012	0.025	0.05	0.1	0.2	0.4	0.8	1.6	3.2	6.3	12.5	25	50
GRADES	N1	N2	N3	N4	N5	N6	N7	N8	N9	N10	N11	N12	
SYMBOLS	▽▽▽			▽▽▽			▽▽			▽		~	
TOLERANCE	MATERIALS:			2022	NAME	DATE		WEMAG 2002262.0400					
FREE DIMENSIONS	16MnCr5			DRAWN	SVR	26/11							
TOLERANCE				CHECKED	RVL	26/11							
Dimns.	Dia	Length	APPROVED			SCALE : NTS QTY. :							
0.5 to 3	±0.05	±0.10	PART NAME:			DRAWING No.		FWS409H-ERM20070					
3 to 6	±0.10	±0.15	SK40CCHER20070MFWW			REV.							
6 to 30	±0.15	±0.20	DRAWING No.			00							
30 to 120	±0.20	±0.25	DATE			00							
120 to 500	±0.30	±0.50	DATE			00							