

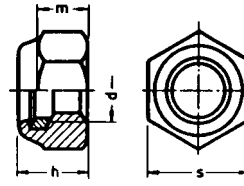

Sicherheitsmutter/U-Scheiben

E-NORM pro DIN 985, Sicherungsmutter, Edelstahl A2



Artikelnr.	Abmessung d	h mm	m mm	s mm	VE	Preis/100 Stk.
9012720.0050	M4	4	3,2	7,0	200	3,00
9012720.0070	M5	5	3,5	8,0	200	3,20
9012720.0090	M6	6	4,5	10,0	200	4,44
9012720.0110	M8	8	6,0	13,0	100	8,88
9012720.0130	M10	10	7,0	17,0	100	18,62
9012720.0150	M12	12	9,0	19,0	50	27,68
9012720.0190	M16	16	11,0	24,0	25	45,65

(5013)

E-NORM pro DIN 9021, große U-Scheibe, verzinkt

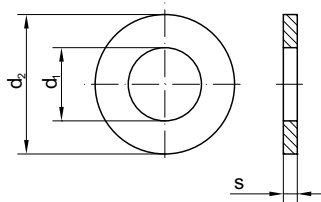

Artikelnr.	Nennmaß, d ₁	d ₂ mm	s mm	Härte	VE	Preis/100 Stk.
9012852.0010	3,2	9,0	0,8	140 HV	1.000	0,78
9012852.0020	4,3	12,0	1,0	140 HV	1.000	1,30
9012852.0030	5,3	15,0	1,2	140 HV	1.000	1,32
9012852.0040	6,4	18,0	1,6	140 HV	1.000	2,28
9012852.0050	8,4	24,0	2,0	140 HV	500	4,68
9012852.0060	10,5	30,0	2,5	140 HV	250	9,72

Artikelnr.	Nennmaß, d ₁	d ₂ mm	s mm	Härte	VE	Preis/100 Stk.
9012852.0070	13,0	37,0	3,0	140 HV	100	14,28
9012852.0080	15,0	44,0	3,0	140 HV	100	21,50
9012852.0090	17,0	50,0	3,0	100 HV	100	25,10
9012852.0100	20,0	56,0	3,0	100 HV	50	39,46
9012852.0110	22,0	60,0	4,0	100 HV	50	50,50

(5013)

E-NORM pro DIN 9021, große U-Scheibe, Edelstahl A2

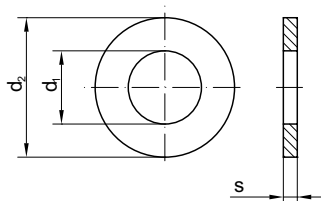

Artikelnr.	Nennmaß, d ₁	d ₂	s	VE	Preis/100 Stk.
9012853.0010	3,2	9,0	0,8	500	1,10
9012853.0020	4,3	12,0	1,0	500	1,42
9012853.0030	5,3	15,0	1,2	500	2,20
9012853.0040	6,4	18,0	1,6	500	3,94

Artikelnr.	Nennmaß, d ₁	d ₂	s	VE	Preis/100 Stk.
9012853.0050	8,4	24,0	2,0	100	9,20
9012853.0060	10,5	30,0	2,5	100	18,98
9012853.0070	13,0	37,0	3,0	50	31,76
9012853.0090	17,0	50,0	3,0	50	45,50

(5013)