

Rev.No.	Ch.Let	Alterations	Date	Sign.	Appd.

All Dimensions are in MM

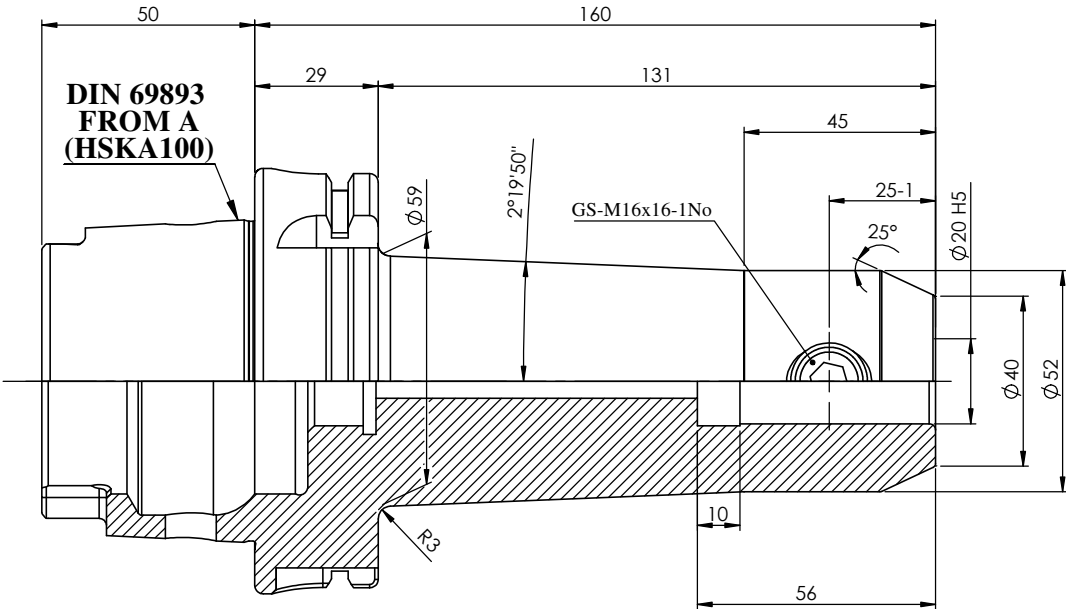
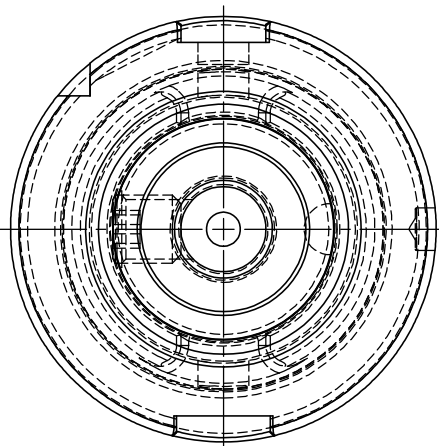
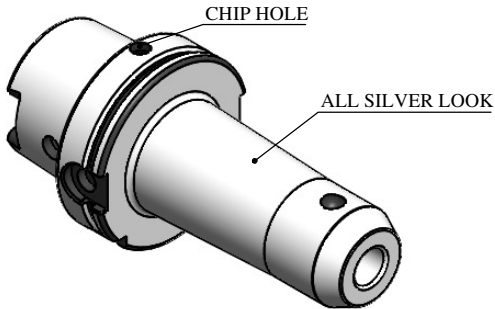

**LABEL :**

2002378.2002  
**WELDON-AUFNAHME**  
**WELDON HOLDER**  
**DIN69893 HSK100A**  
**WE 20 mm x 160 mm**  
**G2,5 25.000 U / MIN**

**MARKING : DIN 69893 A HSK100A WE20 H160**  
**G2.5 25000 U/MIN**

**NOTE :**

**BALANCING 2.5G AT 25000 RPM**

**WEIGHT : 4.1 Kg**

		µm	0.012	0.025	0.05	0.1	0.2	0.4	0.8	1.6	3.2	6.3	12.5	25	50
		GRADES	N1	N2	N3	N4	N5	N6	N7	N8	N9	N10	N11	N12	
		SYMBOLS	▽▽▽▽	▽▽▽	▽▽	▽	~								
TOLERANCE FREE DIMENSIONS TOLERANCE		MATERIALS:	2015	NAME	DATE										
Dimns. Dia Length		16MnCr5	DRAWN	MLCP	29/06										
0.5 to 3	±0.05 ±0.10		CHECKED	RVL	29/06										
3 to 6	±0.10 ±0.15		APPROVED												
6 to 30	±0.15 ±0.20		SCALE :	NTS	QTY. :										
30 to 120	±0.20 ±0.25	PART NAME:													
120 to 500	±0.30 ±0.50	HSK 100EM20160WW													
		DRAWING No.													
		FWA100H-EMH20160													
		REV.													
		00													

ITEM NO.	PART NUMBER	DESCRIPTION	QTY.
1	FWA100H-EMH20160	HSKA100EM20160WW	1
2	GS-M16x16-DIN1835-B	GRUB SCREW	1