

Rev.No.	Ch.Let	Alterations	Date	Sign.	Appd.

All Dimensions are in MM

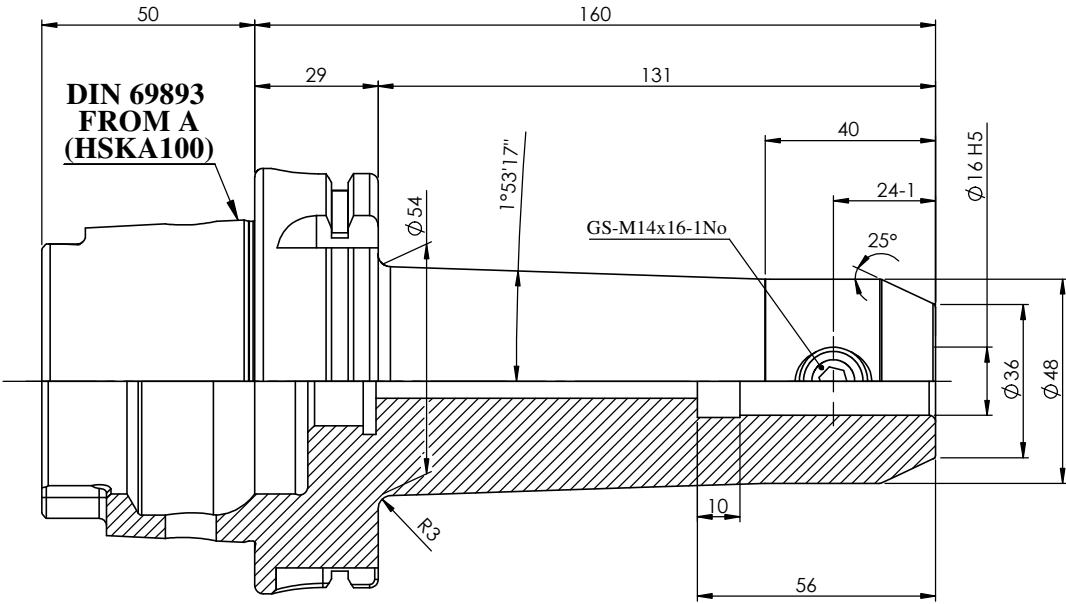
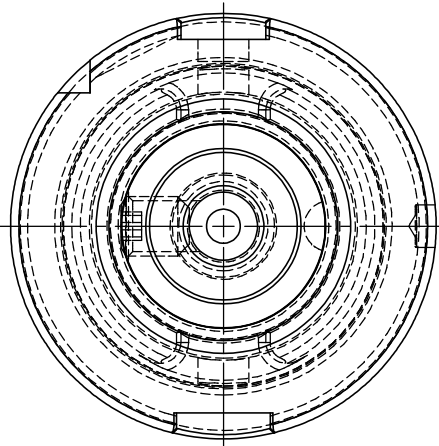
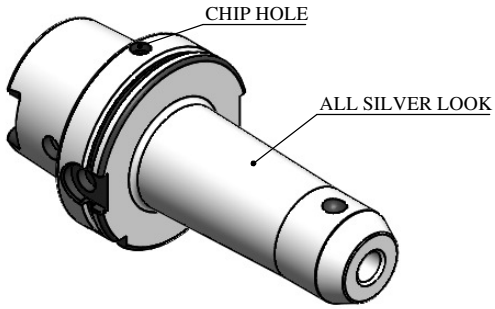

LABEL :

91100A-WE816160
WELDON-AUFNAHME
WELDON HOLDER
DIN69893 HSK100A
WE 16 mm x 160 mm
G2,5 25.000 U / MIN

MARKING : DIN 69893 A HSK100A WE16 H160
G2.5 25000 U/MIN

NOTE :

BALANCING 2.5G AT 25000 RPM

WEIGHT : 3.8 Kg

ITEM NO.	PART NUMBER	DESCRIPTION	QTY.
1	FWA100H-EMH16160	HSKA100EM16160WW	1
2	GS-M14X16-DIN1835-B	GRUB SCREW	1

μm	0.012	0.025	0.05	0.1	0.2	0.4	0.8	1.6	3.2	6.3	12.5	25	50
GRADES	N1	N2	N3	N4	N5	N6	N7	N8	N9	N10	N11	N12	
SYMBOLS	▽▽▽▽	▽▽▽	▽▽	▽	~								
TOLERANCE FREE DIMENSIONS TOLERANCE	MATERIALS: 16MnCr5			2015	NAME	DATE	91100A-WE816160						
Dimns. Dia Length	DRAWN <i>MLCP</i>			29/06	CHECKED <i>RVL</i>								
0.5 to 3 ±0.05 ±0.10	APPROVED			29/06	SCALE : NTS QTY. :								
3 to 6 ±0.10 ±0.15	PART NAME:			HSK 100EM16160WW				DRAWING No.				REV.	
6 to 30 ±0.15 ±0.20								FWA100H-EMH16160				00	
30 to 120 ±0.20 ±0.25													
120 to 500 ±0.30 ±0.50													