

Rev.No.	Ch.Let	Alterations	Date	Sign.	Appd.

All Dimensions are in MM

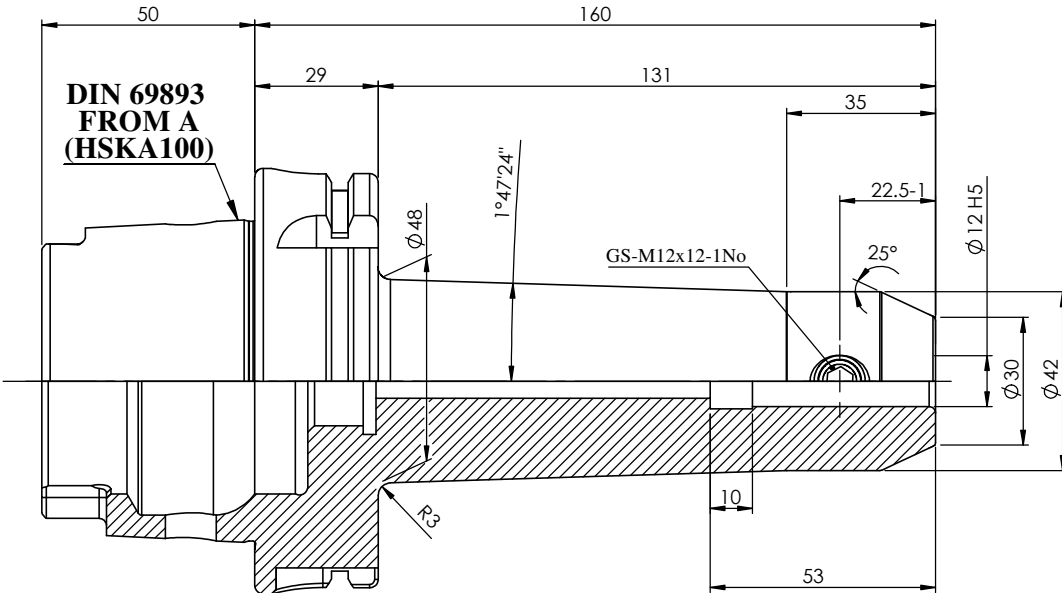
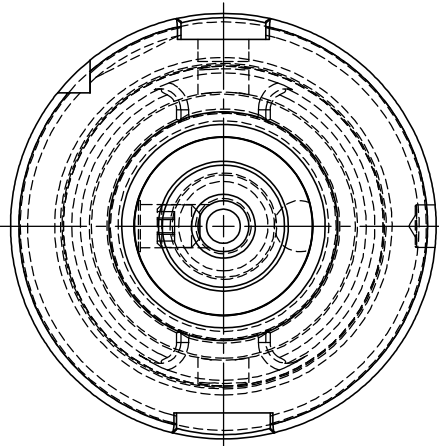
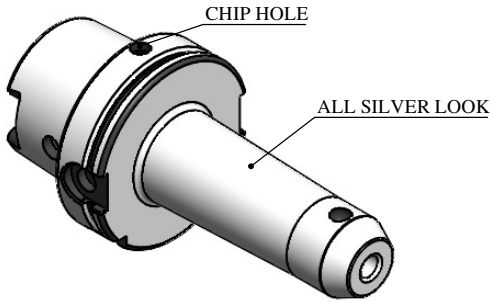

LABEL :

**2002378.1202
WELDON-AUFNAHME
WELDON HOLDER
DIN69893 HSK100A
WE 12 mm x 160 mm
G2,5 25.000 U / MIN**

**MARKING : DIN 69893 A HSK100A WE12 H160
G2.5 25000 U/MIN**

NOTE :

BALANCING 2.5G AT 25000 RPM

WEIGHT : 3.4 kg

μm	0.012	0.025	0.05	0.1	0.2	0.4	0.8	1.6	3.2	6.3	12.5	25	50
GRADES	N1	N2	N3	N4	N5	N6	N7	N8	N9	N10	N11	N12	
SYMBOLS	▽▽▽▽	▽▽▽	▽▽	▽	~								

TOLERANCE FREE DIMENSIONS TOLERANCE		MATERIALS: 16MnCr5	2015	NAME	DATE
Dimns.	Dia	Length	DRAWN	MLCP	24/08
0.5 to 3	±0.05	±0.10	CHECKED	RVL	24/08
3 to 6	±0.10	±0.15	APPROVED		
6 to 30	±0.15	±0.20	SCALE : NTS	QTY. :	
30 to 120	±0.20	±0.25	PART NAME: HSK 100EM 12 160WW		DRAWING No. FWA100H-EMH12160
120 to 500	±0.30	±0.50			REV. 00

2002378.1202

ITEM NO.	PART NUMBER	DESCRIPTION	QTY.
1	FWA100H-EMH12160	HSKA100EM12160WW	1
2	GS-M10X10	GRUB SCREW M10X10	1