

Rev.No.	Ch.Let	Alterations	Date	Sign.	Appd.

All Dimensions are in MM

For Customer Approval

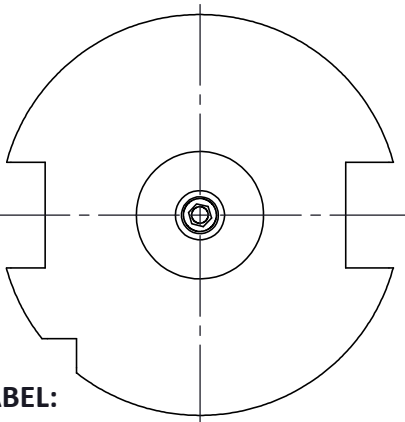
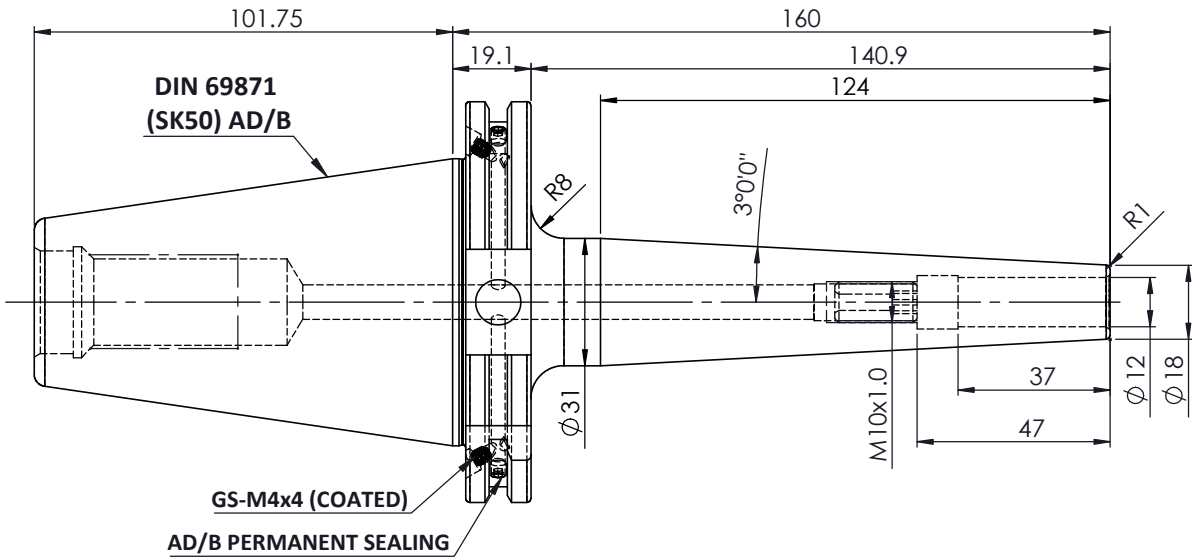
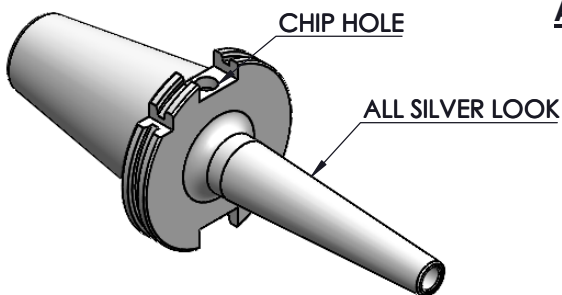

LABEL:

2002375.1202
SCHRUMPFUTTER SCHLANK 3°
SHRINK FIT HOLDER SLIM 3°
ISO 7388-1 (DIN69871) SK50 AD/AF (AD+B)
SRS2 12mm X 160mm
G2.5/25000 U/MIN

MARKING: ISO 7388-1 (DIN69871) SK50 AD/AF (AD+B) SFHS12 H160
G2.5 25000 U/MIN

ITEM NO.	PART NUMBER	DESCRIPTION	QTY.
4	SCWM10x1x20	STOPPER SCREW	1
3	GS-M4X4 COATED	GRUB SCREW	2
2	GS-M4X4	GRUB SCREW-(B.O)	2
1	FWS509H-SFS12160	SK50SFS12160FWW	1

Notes	
Balancing Value	G2.5 @ 25000 RPM
Approx Weight	3.1Kg

	µ m	0.012	0.025	0.05	0.1	0.2	0.4	0.8	1.6	3.2	6.3	12.5	25	50
GRADES		N1	N2	N3	N4	N5	N6	N7	N8	N9	N10	N11	N12	
SYMBOLS		▽▽▽	▽▽	▽	▽	▽	▽	▽	▽	▽	▽	▽	▽	~
TOLERANCE FREE DIMENSIONS		MATERIALS: HDS		2024	NAME	DATE	2002375.1202							
TOLERANCE		DRAWN		YSK	30/08									
Dimns.	Dia	Length	CHECKED		RVL	30/08								
0.5 to 3	± 0.05	± 0.10	APPROVED											
3 to 6	± 0.10	± 0.15	SCALE: NTS		QTY. :									
6 to 30	± 0.15	± 0.20	PART NAME:				DRAWING No.				REV.			
30 to 120	± 0.20	± 0.25	SK50SFS12160FWW				FWS509H-SFS12160				00			
120 to 500	± 0.30	± 0.50												