

Rev.No.	Ch.Let	Alterations	Date	Sign.	Appd.

All Dimensions are in MM

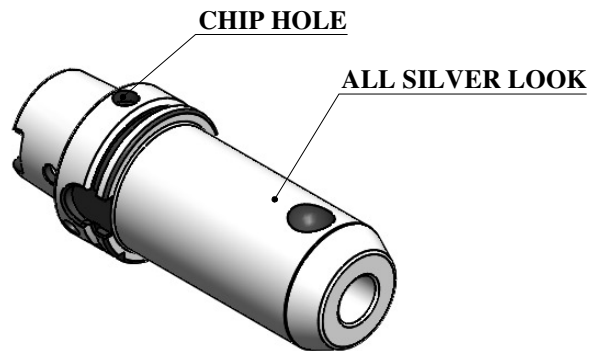

DIN69893  
FORMA  
HKA63

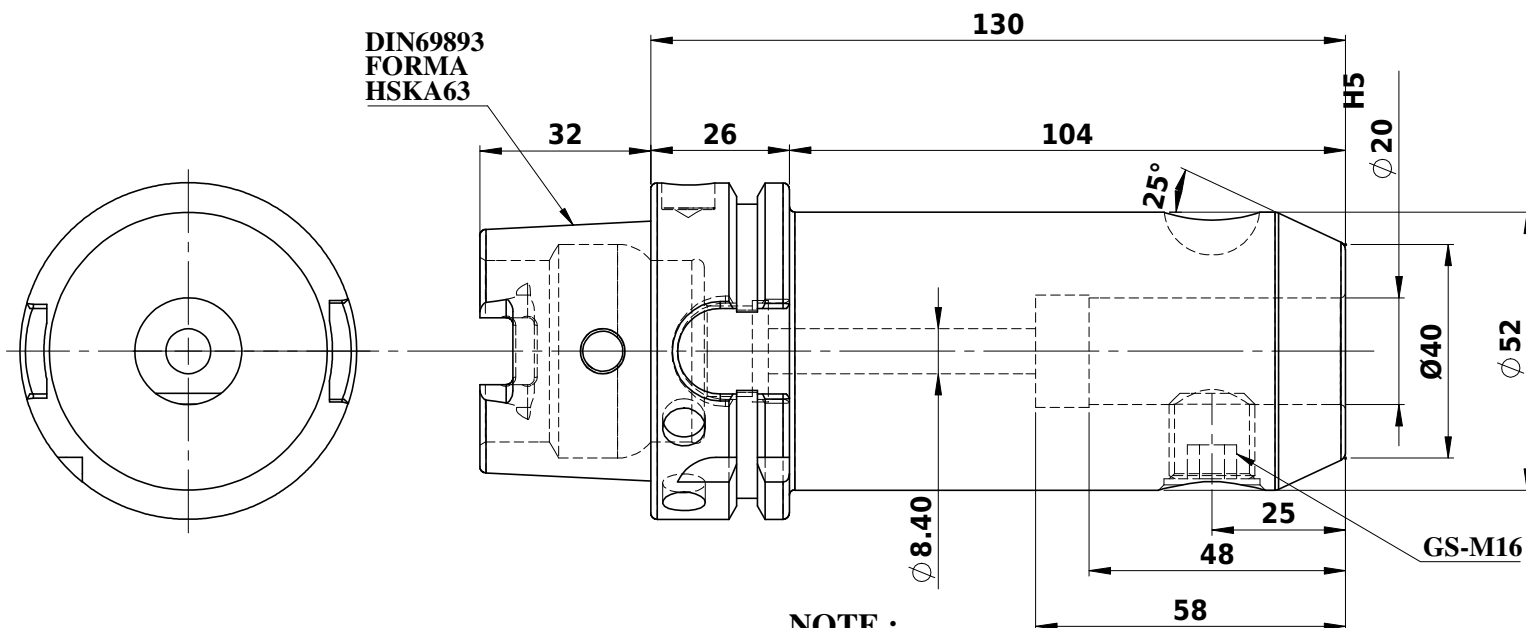

**LABEL :**  
2002270.2005  
WELDON-AUFNAHME WELDON  
HOLDER DIN69893 HSK63A WE 20  
mm x 130 mm G2,5 / 25000 U/MIN

**NOTE :**  
BALANCING 2.5G AT 25000 RPM

**WEIGHT : 2.12 kg**

**MARKING : DIN 69893 A HSK63A WE20H130  
G2.5 25000 U/MIN**

µm	0.012	0.025	0.05	0.1	0.2	0.4	0.8	1.6	3.2	6.3	12.5	25	50
GRADES	N1	N2	N3	N4	N5	N6	N7	N8	N9	N10	N11	N12	
SYMBOLS	▽▽▽			▽▽▽			▽▽			▽		~	
TOLERANCE	MATERIALS:			2017	NAME	DATE	<b>2002270.2005</b>						
FREE DIMENSIONS	16MnCr5			DRAWN	KFK	18/08							
TOLERANCE	Dimns.			CHECKED	RVL	18/08							
	Dimns. Dia Length			APPROVED									
0.5 to 3	±0.05	±0.10			SCALE : NTS QTY. :								
3 to 6	±0.10	±0.15											
6 to 30	±0.15	±0.20											
30 to 120	±0.20	±0.25											
120 to 500	±0.30	±0.50											
PART NAME:						DRAWING No.		REV.					
<b>HKA63EM20130WW</b>						<b>FWA063H-EMH20130</b>		<b>00</b>					

ITEM NO.	PART NUMBER	DESCRIPTION	QTY.
1	FWA063H-EMH20130	HKA63EM20130WW	1
2	GS-M16X16	GRUB SCREW	1