

Rev.No.	Ch.Let	Alterations	Date	Sign.	Appd.

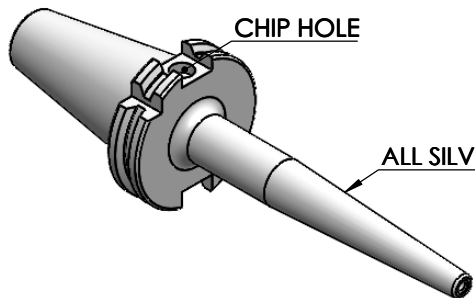

CHIP HOLE

ALL SILVER LOOK

All Dimensions are in MM

For Customer Approval

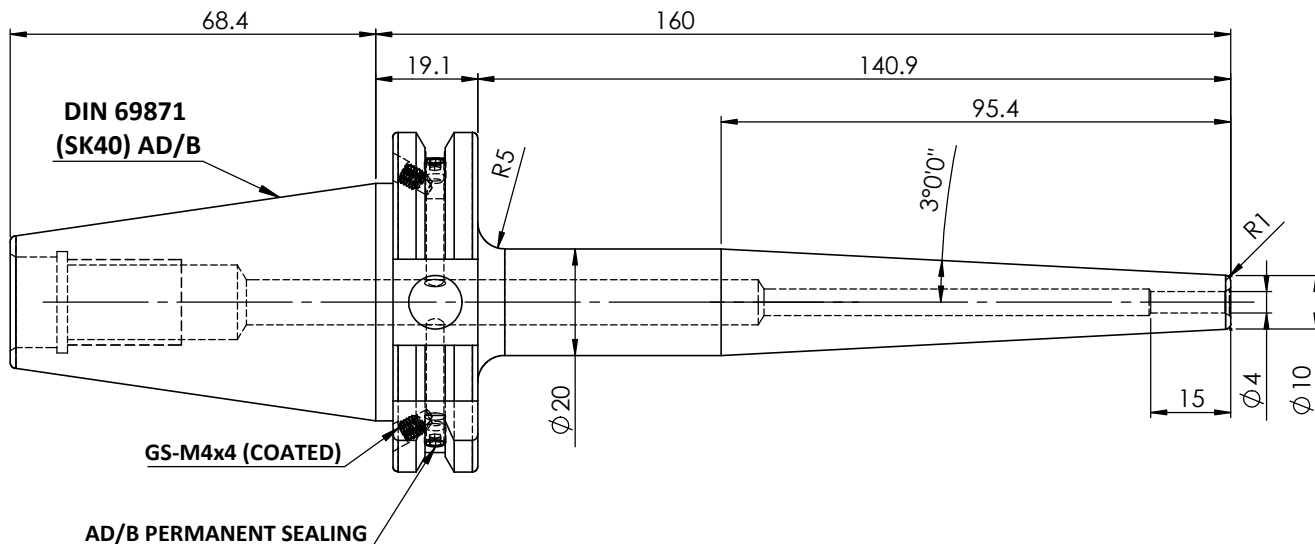

LABEL:

2002267.0402
 SCHRUMPFUTTER SCHLANK 3°
 SHRINK FIT HOLDER SLIM 3°
 ISO 7388-1 (DIN69871) SK40 AD/AF (AD+B)
 SRS2 04mm X 160mm
 G2.5/25000 U/MIN

MARKING: ISO 7388-1 (DIN69871) SK40 AD/AF (AD+B) SFHS04 H160
 G2.5 25000 U/MIN

Notes	
Balancing Value	G2.5 @ 25000 RPM
Approx Weight	1.0Kg

µ m	GRADES																								
	0.012	0.025	0.05	0.1	0.2	0.4	0.8	1.6	3.2	6.3	12.5	25	50												
	✓	✓	✓	✓	✓	✓	✓	✓	✓	✓	✓	✓	✓												
	N1			N2		N3		N4		N5		N6		N7		N8		N9		N10		N11		N12	
	SYMBOLS												▽▽▽	▽▽	▽	~									
TOLERANCE FREE DIMENSIONS TOLERANCE		MATERIALS: HDS		NAME		DATE		2002267.0402																	
Dimns. Dia Length		DRAWN		YSK		28/08																			
0.5 to 3 ± 0.05 ± 0.10		CHECKED		RVL		28/08																			
3 to 6 ± 0.10 ± 0.15		APPROVED																							
6 to 30 ± 0.15 ± 0.20		SCALE: NTS		QTY.:		PART NAME: SK40SFS04160FWW																			
30 to 120 ± 0.20 ± 0.25		DRAWING No.		FWS409H-SFS04160												REV. 00									
120 to 500 ± 0.30 ± 0.50																									

ITEM NO.	PART NUMBER	DESCRIPTION	QTY.
3	GS-M4X4 COATED	GRUB SCREW	2
2	GS-M4X4	GRUB SCREW-(B.O)	2
1	FWS409H-SFS04160	SK40SFS04160FWW	1